

High Flow High HP Auger Drives

For skid-steer loaders and mid-sized excavators



PALADIN LIGHT CONSTRUCTION

FEATURES:

- 24 to 54 GPM available
- Augers available up to 48" diameter
- Wide variety of auger diameters, lengths and style for every digging application
- All system pressure translates into torque and productivity, no pressure reducers are used
- Extensions available for deeper digging
- Various mounts available for most applications
- 2 year warranty; up to 3 years additional planetary warranty



Fit-Up Chart

		Maximum Flow (GPM)																		
		Model	24	26	28	30	32	34	36	38	40	42	44	46	48	50	52	54		
Maximum Pressure (PSI)	1500	3575	45	48	58	56														
		4075																		
		5075																		
		6075																		
		8075																		
	2000	3575	45	48	52	56														
		4075	58	63	68	73	48	83												
		5075			59	63	68	72	76	80	85									
		6075				51	54	57	61	64	68	72	74	78	81	85	88	91		
		8075							42	45	47	50	52	54	57	59	61	64		
	2500	3575	45	48	52	56														
		4075	58	63	68	73	78	83												
		5075			59	63	68	72	76	80	85									
		6075				51	54	57	61	64	68	72	74	78	81	85	88	91		
		8075							42	45	47	50	52	54	57	59	61	64		
	3000	3575	45	48	52	56														
		4075	58	63	68	73	78	83												
		5075			59	63	68	72	76	80	85									
		6075				51	54	57	61	64	68	72	74	78	81	85	88	91		
		8075							42	45	47	50	52	54	57	59	61	64		
3500	3575																			
	4075	58	63	68	73	78	83													
	5075			59	63	68	72	76	80	85										
	6075				51	54	57	61	64	68	72	74	78	81	85	88	91			
	8075							42	45	47	50	52	54	57	59	61	64			
4000	3375																			
	4075	58	63	68	73	78	83													
	5075																			
	6075																			
	8075																			

RPMs

RPMs

McMillen
 PH: (800) 922-2981
 FX: (563) 922-2700
 P.O. Box 266
 Delhi, IA 52223-0266
 United States of America
 www.paladinbrands.com

Mid-Range Auger Drives 0706-1



PALADIN LIGHT CONSTRUCTION

Specifications

2 Year Comprehensive Warranty - Case Drain Line Required

3575 AUGER DRIVE (CASE DRAIN LINE REQUIRED)

maximum auger diameter:	48"		
hydraulic flow (GPM):	24 to 30		
maximum continuous operating PSI:	2500		
maximum working back pressure:	300		
output shaft options:	2" hex		
output speed	output torque		
flow (GPM)	speed (RPM)	pressure (PSI)*	torque (Lb-Ft)
24	45	1500	2472
27	50	2000	3296
30	56	2500	4120

4075 AUGER DRIVE (CASE DRAIN LINE REQUIRED)

maximum auger diameter:	48"		
hydraulic flow (GPM):	24 to 32		
maximum continuous operating PSI:	4000		
maximum working back pressure:	300		
output shaft options:	2" hex		
output speed:	output torque:		
flow (GPM)	speed (RPM)	pressure (PSI)	torque (Lb-Ft)
24	58	2500	3155
28	68	3000	3786
30	73	3500	4417
32	78	4000	5048

5075 AUGER DRIVE (CASE DRAIN LINE REQUIRED)

maximum auger diameter:	48"		
hydraulic flow (GPM):	28 to 40		
maximum continuous operating PSI:	3500		
maximum working back pressure:	300		
output shaft options:	2" hex		
output speed	output torque		
flow (GPM)	speed (RPM)	pressure (PSI)	torque (Lb-Ft)
28	59	2500	3620
34	72	3000	4345
40	85	3500	5069

6075 AUGER DRIVE (CASE DRAIN LINE REQUIRED)

maximum auger diameter:	48"		
hydraulic flow (GPM):	30 to 53		
maximum continuous operating PSI:	3500		
maximum working back pressure:	300		
output shaft options:	2" hex		
output speed	output torque		
flow (GPM)	speed (RPM)	pressure (PSI)	torque (Lb-Ft)
30	51	2500	4531
42	71	3000	5437
53	90	3500	6343

8075 AUGER DRIVE (CASE DRAIN LINE REQUIRED)

maximum auger diameter:	48"		
minimum hydraulic flow (GPM):	36 to 54		
maximum continuous operating PSI:	3500		
maximum working back pressure:	300		
output shaft options:	2½" hex		
output speed	output torque		
flow (GPM)	speed (RPM)	pressure (PSI)	torque (Lb-Ft)
36	42	2500	6493
45	53	3000	7791
54	64	3500	9090

McMillen
 PH: (800) 922-2981
 FX: (563) 922-2700
 P.O. Box 266
 Delhi, IA 52223-0266
 United States of America
 www.paladinbrands.com

Mid-Range Auger Drives 0706-1



PALADIN LIGHT CONSTRUCTION

Augers

2 year warranty on all Augers

Heavy Duty - HDC Style Augers *For difficult ground conditions, compacted soils, heavy clay, asphalt, frozen ground & fracturable rock*

HDC Features:

- heavy duty cast steel boring head
- hardened drive-in gage teeth (outside positions)
- hardened drive-in wisdom teeth (inside positions)
- hardened fishtail point
- heavy-duty, double flighting
- collars available in 2" round, 2-9/16" round, and 2" hex
- available in 3', 4', 5' & 6' lengths

Diameter IN	MM	Tooth QTY
6"	152	2
8"	203	4
9"	229	4
10"	254	4
12"	305	4
15"	381	6
16"	406	6
18"	457	6
20"	508	6
24"	610	8
30"	762	10
36"	914	12
42"	1067	16
48"	1219	18



Medium Duty - HDF Style Augers *For light to moderate ground conditions*

HDF Features:

- fabricated boring head
- hardened bolt-on gage teeth (outside positions)
- hardened bolt-on wisdom teeth (inside positions)
- hardened fishtail point
- heavy duty double flighting
- collars available in 2" round, 2-9/16" round, and 2" hex
- available in 3', 4', 5' & 6' lengths

Diameter IN	MM	Tooth QTY
4"	102	NA
6"	152	2
8"	203	2
9"	229	3
10"	254	3
12"	305	4
15"	381	5
16"	406	5
18"	457	6
20"	507	6
24"	610	8
30"	762	9
36"	914	11

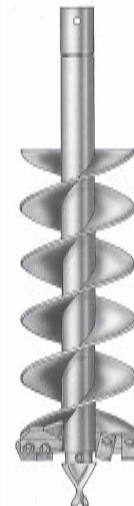

HTF Style Auger - Tree Auger *For tree and shrub planting*

HTF Features:

- 2 diameter design
- fabricated boring head
- hardened bolt-on gage teeth (outside positions)
- hardened bolt-on wisdom teeth (inside positions)
- hardened fishtail point
- heavy-duty double flighting
- collars available in 2" round, 2-9/16" round, and 2" hex
- available in 4' length

Diameter		Tooth QTY	Auger Size	Dimensional Information			
IN	MM			A overall	B flighting	C flighting	D Pilot Dia.
18"	457	7	4'	48"	18"	7"	9"
24"	610	10	4'	48"	12"	12"	12"
30"	762	11	4'	48"	15"	8"	15"
36"	914	13	4'	48"	18"	6"	18"
42"	1067	15	4'	48"	11"	6"	18"
48"	1219	17	4'	48"	12"	6"	24"

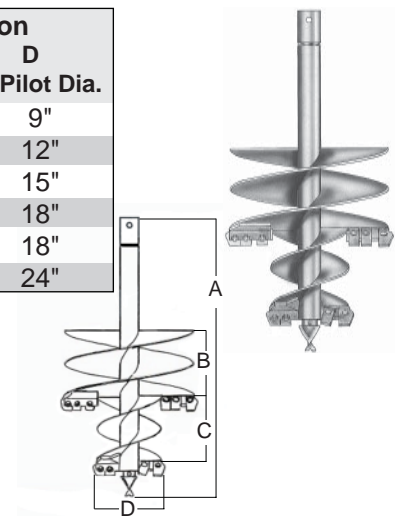

Specifications and design are subject to change without notice and without liability, therefore, whenever applicable specifications are in accordance with SAE standards.

Augers

2 year warranty available

Rock Augers - Bullet Tooth Style *For solid, fracturable rock, frozen ground & compacted soils*

Rock Auger Features:

- bullet style teeth
- fabricated boring head
- heavy duty single flighting
- 2" hexagon collar **ONLY**
- available in 4' length
- 3/4 thick bottom flight
- hardfaced outer edge

Diameter		Tooth
IN	MM	QTY
6"	152	6
9"	229	8
10"	254	8
12"	305	12
16"	406	16
18"	457	18
20"	508	20
24"	610	24
30"	762	30
36"	914	36



Agricultural PTO Augers

Designed to fit all PTO drive units with 2" round output shafts

Agricultural PTO Auger Features:

- fabricated boring head
- hardened bolt-on gage teeth (outside)
- hardened bolt-on wisdom teeth (inside)
- hardened fishtail point
- heavy-duty double flighting
- PTO augers available in 42"/48" length

Diameter		Tooth
IN	MM	QTY
6"	152	2
9"	229	2
12"	305	4
14"	325	5
18"	457	6
24" tree	610	9



Medium Duty - MDF Style Augers

For light to moderate ground conditions

MDF Auger Features:

- fabricated boring head
- outside bolt-on gage teeth & wisdom teeth
- standard or carbide teeth and point available
- heavy-duty, 5/16" thick flighting
- available with standard or carbide wear components
- heavy-duty center shaft, 3¾" tubing x 5/16" wall
- collars available in 2½" hexagon and 2-5/8" hexagon



Diameter		Flighting Length	Tooth QTY	Overall Length
IN	MM			
8"	203	40" or 60"	2	103"
9"	229	40" or 60"	2	103"
10"	254	40" or 60"	2	103"
12"	305	40" or 60"	4	103"
14"	325	40" or 60"	4	103"
16"	406	40" or 60"	4	103"
18"	457	40" or 60"	6	103"
20"	508	40" or 60"	6	103"
24"	610	40" or 60"	7	103"
30"	762	40" or 60"	8	103"
36"	914	40" or 60"	8	103"
42"	1067	40" or 60"	10	103"
48"	1219	40" or 60"	13	103"



Heavy Duty - MDC Style Augers

For difficult ground conditions, compacted soils, heavy clay, asphalt, frozen ground & fracturable rock

MDC Auger Features:

- heavy-duty cast steel boring head
- outside drive-in gage teeth & inside wisdom teeth
- standard or carbide teeth and point available
- heavy-duty, 5/16" thick flighting
- available with standard or carbide wear components
- heavy-duty center shaft, 3¾" tubing x 5/16" wall
- collars available in 2½" hexagon and 2-5/8" hexagon

Specifications and design are subject to change without notice and without liability, therefore, whenever applicable specifications are in accordance with SAE standards.

Auger Accessories

Auger Adaptors

Output Shaft Size			Collar Opening Size		
IN	Type	MM	IN	Type	MM
2"	round	51	2"	hexagon	51
2"	hexagon	51	2"	round	51
2"	round	51	2-9/16"	round	65
2-9/16"	round	65	2"	round	51
2"	hexagon	51	2-9/16"	round	65
2-9/16"	round	65	2"	hexagon	51
2"	hexagon	51	2½"	hexagon	64
2½"	hexagon	64	2"	hexagon	51

Adaptors couple McMillen® Drive Units to competitive augers or McMillen Augers to competitive drive units. Determine drive unit output shaft and collar opening sizes and types (round or hexagon) to select proper adaptor.

Fixed Length Auger Extensions



Ext. Length	2"	2-9/16"	2"	2½"	2-5/8"
IN	MM	round	round	hex	hex
12"	305	R2	R256	H2	
18"	457	R2	R256	H2	
24"	610	R2	R256	H2	
48"	1219	R2	R256	H2	
72"	1829	R2	R256	H2	H25 H265

Fixed length auger extensions extended the augers digging depth to exactly the length of the extension. McMillen® Fixed Length Extensions are available with 2" round, 2-9/16" round, 2" hexagon, 2½" hexagon, or 2-5/8" hexagon collars. These extensions do not store within the auger.

Variable Length Auger Extensions

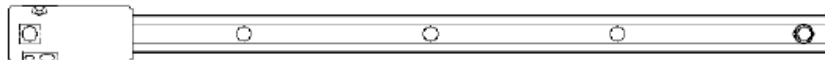

Ext. Length	2"	2-9/16"	2"	2½"	2-5/8"
IN	MM	round	round	hex	hex
12"	305	R2	R256	H2	
18"	457	R2	R256	H2	
24"	610	R2	R256	H2	
48"	1219	R2	R256	H2	
72"	1829	R2	R256	H2	H25 H265

Variable length auger extensions store inside the center tube of the augers that are 10" diameter or larger. Extension increments are every 6" on 12" through 24" extensions and every 12" on 48" and 72" extensions. Variable Length Extensions are available with 2" round, 2-9/16" round, 2" hexagon, 2½" hexagon, or 2-5/8" hexagon collars.

Wisdom Tooth
(part #22168)

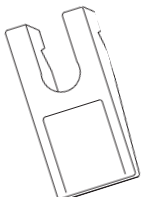

Gage Tooth
(part #22169)

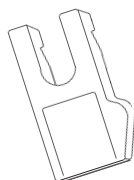

Fishtail (female)
(part #22171)



Fishtail (male)
(part #22190)



Carbide Tooth
(part #22186)

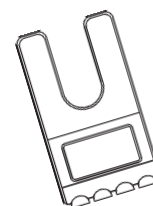

Chisel Tooth
(part #22181)



Specifications and design are subject to change without notice and without liability, therefore, whenever applicable specifications are in accordance with SAE standards.